

BOBCAT COMPANY PRICE PAGES

UTILITY VEHICLES



Please note the following when using Bobcat Price Pages:

- All prices are shown in U.S. dollars.
- Check BobcatdealerNET Pricing Homepage for current Canadian exchange rate.
- For current Dealer Installed Accessories pricing, reference BobQuote or Dealer Parts Department
- Prices and specifications are subject to change without notice.

THE FOLLOWING UPDATES HAVE BEEN MADE TO THIS DOCUMENT:

Date	Description of Change
4/15/2021	Shipping fee increase for UV34 & UV34XL
6/7/2021	Effective Monday, June 7th, 2021 Bobcat Company has adjusted the SLP.
11/1/2021	Effective Monday, November 1st, 2021 Bobcat Company has adjusted the SLP of power units.
2/21/2022	New 2022 Model Year Release
4/15/2022	Destination charge increase
7/1/2022	Cab & Heat price update
10/1/2022	New 2023 Model Year Release (Model year removal from ordering going forward)
1/1/2023	Bobcat Company has adjusted the SLP of power units
3/1/2023	Bobcat Company has adjusted the SLP of power units due to a calculation error
7/1/2023	Bobcat Company has adjusted the SLP of power units
9/15/2023	Added New Snow Blade Attachments
1/1/2024	Bobcat Company has adjusted the SLP of power units
5/1/2024	Bobcat Company has adjusted the SLP of power units
10/21/2024	Updated accessory offering
1/1/2025	Updated accessory offering
3/1/2025	Bobcat Company has adjusted the SLP of power units
12/4/2025	Added Broadcast and Drop Spreaders
12/9/2025	Bobcat Company has adjusted the SLP of power units and options

**Certain Specification(s) are based on engineering calculations and are not actual measurements. Specification(s) are provided for comparison purposes only and are subject to change without notice. Specification(s) for your individual Bobcat equipment will vary based on normal variations in design, manufacturing, operating conditions, and other factors.*

UV34 Bobcat Utility Vehicle



Standard Equipment

Engine

- Liquid Cooled Engines
- Engine protection Oil pressure & Water Temp
- Pressurized Oil System w/ spin on filter
- High Capacity Air Filter

Drive System

- CVT (Continuous Variable Transmission)
- Sealed CVT w/remote intake and exhaust
- Transmission 2 Forward & 1 Reverse Range
- Integrated In-Transmission Vehicle Park
- 4 Wheel Hydraulic Disc Brakes w/ dual-bore front calipers
- CV Joints on Drive and Half Shafts
- CV Guards, Front
- Drive Modes (All-wheel, 2-Lock Diff, 1-Open Diff)

Steering & Suspension

- Front & Rear Independent, Dual A-Arm
- 4 Coil Over Shocks w/Adjustable Spring Preloads
- Rack & Pinion w/Electric Power Steering
- Tilt Steering

Operator Comfort

- 3 Occupant Bench Seating (40/60 Split)
- 3-PT Seat Belts w/Shoulder Comfort Strap
- 12v Power Ports
- USB Charging Ports & Battery Charing Port
- Beverage holders (6)
- Storage; Upper Dash, Lower Dash, & Underseat
- Sealed Glove Box Storage

Tires & Wheels

- Industrial All-Terrain Non-Directional 8-ply
- Front/Rear; 26x10-12
- Front/Rear; Orange Steel Rim 12x6

Electrical

- Headlights; High & Low Beams 4 @ 35 Watts
- LED Rear Marker & Brake Lights
- High output electrical systems
- 575 CCA Battery
- 6 Position Power Bar for Accessories

Instrumentation

- LCD Display w/Color Select
- Digital Display of Speedo, Tachometer, Engine Temp, Volts, Trip & Hour Meter, Clock, 4-Wheel Drive Mode, Service Reminder, Service Codes, and Gear Position
- Indicator Lights; Glow Plugs, Seatbelts, High Beam, Check Engine, Low Oil Pressure, & High Engine Temp

Frame & Cargo Box

- ROPS (Roll Over Protective Structure)
- Profiled ROPS Structure; Field Cab Ready
- Chassis Skid Plates
- 2" Rear Receiver
- Composite Cargo Box w/ Cylinder Lift Assist
- Single Latch Tailgate

Warranty

- 1 Year/ 1000 HRS

Quick Specs

	<u>Diesel</u>	<u>Gas</u>
Engine Displacement.....	989 cc	999 cc
Horsepower.....	23.5 HP	40 hp
Fuel Delivery.....	Indirect Injection	Electronic Fuel Injection
Travel Speed Forward (High/Low).....	35 MPH/16 MPH	35 MPH/25 MPH
Vehicle Speed Setting Factory (w/Speed Kits).....	35 MPH (25, & 15)	15-35 MPH (40)
Shipping Weight.....	1697 lbs	1658 lbs
Vehicle Dimensions (Length x Width x Height).....	123x62x76 in.	123x62x76 in.
Turning Radius.....	9.2 ft.	9.2 ft.
Ground Clearance.....	11.7 in.	11.7 in.

Quick Specs - Cont.

	<u>Diesel</u>	<u>Gas</u>
Fuel Capacity.....	11.5 gal	11.5 gal
Cargo Box Volume.....	15.6 cubic ft.	15.6 cubic ft.
Cargo Box Inside Dimensions (LxWxH).....	43.5x54x11.5 in.	43.5x54x11.5 in.
Cargo Box Load Height.....	38 in.	38 in.
Vehicle Rated Capacity.....		
- Combined weight of passengers, cargo box, and accessories.....	1800 lbs	1850 lbs
- Towing Capacity.....	2500 lbs	2500 lbs
- Tongue Weight.....	250 lbs	250 lbs
- Cargo Box Capacity.....	1250 lbs	1250 lbs

Part Number	Description	Utility Vehicle	SLP in US \$
M1501	UV34 Diesel.....		\$21,745
M1503	UV34 Gas.....		\$20,049
M1509	UV34 Gas California.....		\$20,430

Part Number	Description	Factory installed Cab & Heat	SLP in US \$
M1501-P01-C03	UV34 Diesel Cab & Heat Package.....		\$8,592
	Factory installation of premium sport roof, poly rear window, fixed glass front window, premium doors, windshield wipers, and deluxe heater w/defrost.		
M1503-P01-C03	UV34 Gas Cab & Heat Package.....		\$8,592
	Factory installation of premium sport roof, poly rear window, fixed glass front window, premium doors, windshield wipers, and deluxe heater w/defrost.		

Part Number	Description	Destination Charge	SLP in US \$
M1501_FREIGHT	UV34 Diesel.....		\$1,420
M1503_FREIGHT	UV34 Gas.....		\$1,420
M1509_FREIGHT	UV34 Gas California.....		\$1,420

Dealer Installed Accessories for the UV34 are located after the UV34XL Utility Vehicle section

UV34 XL Bobcat Utility Vehicle



Standard Equipment

Engine

- Liquid Cooled Engines
- Engine protection Oil pressure & Water Temp
- Pressurized Oil System w/ spin on filter
- High Capacity Air Filter

Drive System

- CVT (Continuous Variable Transmission)
- Sealed CVT w/remote intake and exhaust
- Transmission 2 Forward & 1 Reverse Range
- Integrated In-Transmission Vehicle Park
- 4 Wheel Hydraulic Disc Brakes w/ duel piston front calipers
- CV Joint on Drive and Half Shafts
- CV Guards, Front & Rear
- Drive Modes (All-wheel, 2-Lock Diff, 1-Open Diff)

Steering & Suspension

- Front & Rear Independent, Dual A-Arm
- 4 Coil Over Shocks w/Adjustable Spring Preloads
- Rack & Pinion w/Electric Power Steering
- Tilt Steering

Operator Comfort

- 6 Occupant Bench Seating (40/60 Split)
- 6-PT Seat Belts w/Shoulder Comfort Strap
- 2-12v Power Ports
- USB Charging Ports & Battery Charing Port
- Beverage holders (8)
- Storage; Upper Dash, Lower Dash, & Underseats
- Sealed Glove Box Storage

Tires & Wheels

- Industrial All-Terrain Non-Directional 8-ply
- Front/Rear; 26x10-12
- Front/Rear; Orange Steel Rim 12x6

Electrical

- Headlights; High & Low Beams 4 @ 35 Watts
- LED Rear Marker & Brake Lights
- High output electrical systems
- 575 CCA Battery
- 6 Position Power Bar for Accessories

Instrumentation

- LCD Display w/Color Select
- Digital Display of Speedo, Tachometer, Engine Temp, Volts, Trip & Hour Meter, Clock, 4-Wheel Drive Mode, Service Reminder, Service Codes, and Gear Position
- Indicator Lights; Glow Plugs, Seatbelts, High Beam, Check-Engine, Low Oil Pressure, & High Engine Temp

Frame & Cargo Box

- ROPS (Roll Over Protective Structure)
- Profiled ROPS Structure; Field Cab Ready
- Full Chassis Skid Plates
- 2" Rear Receiver
- Composite Cargo Box w/ Cylinder Lift Assist
- Single Latch Tailgate

Warranty

- 1 Year/ 1000 HRS

Quick Specs

	<u>Diesel</u>	<u>Gas</u>
Engine Displacement.....	989 cc	999 cc
Horsepower.....	23.5 HP	40 hp
Fuel Delivery.....	Indirect Injection	Electronic Fuel Injection
Travel Speed Forward (High/Low).....	35 MPH/16 MPH	35 MPH/25 MPH
Vehicle Speed Setting Factory (w/Speed Kits).....	35 MPH (25, & 15)	15-35 MPH (40)
Shipping Weight.....	2003 lbs	1933 lbs
Vehicle Dimensions (Length x Width x Height).....	155x62x76 in.	155x62x76 in.
Turning Radius.....	12.8 ft.	12.8 ft.

UV34 XL Bobcat Utility Vehicle

Quick Specs - Cont.

	<u>Diesel</u>	<u>Gas</u>
Ground Clearance.....	11.7 in.	11.7 in.
Fuel Capacity.....	11.5 gal	11.5 gal
Cargo Box Volume.....	15.6 cubic ft.	15.6 cubic ft.
Cargo Box Inside Dimensions (LxWxH).....	43.5x54x11.5 in.	43.5x54x11.5 in.
Cargo Box Load Height.....	38 in.	38 in.
Vehicle Rated Capacity.....		
- Combined weight of passengers, cargo box, and accessories.....	1900 lbs	2000 lbs
- Towing Capacity.....	2500 lbs	2500 lbs
- Tongue Weight.....	250 lbs	250 lbs
- Cargo Box Capacity.....	1250 lbs	1250 lbs

Part Number	Description	Utility Vehicle	SLP in US \$
M1505	UV34XL Diesel.....		\$ 22,335.00
M1507	UV34XL Gas.....		\$ 21,270.00
M1511	UV34XL Gas California Base Package EPS.....		\$ 21,654.00

Part Number	Description	Factory installed Cab & Heat	SLP in US \$
M1505-P01-C03	UV34XL Diesel Cab & Heat Package.....		\$12,581
	Factory installation of premium sport roof, poly rear window, fixed glass front window, premium doors(front and rear), windshield wipers, and deluxe heater w/defrost.		
M1507-P01-C03	UV34XL Gas Cab & Heat Package.....		\$12,581
	Factory installation of premium sport roof, poly rear window, fixed glass front window, premium doors(front and rear), windshield wipers, and deluxe heater w/defrost.		

Part Number	Description	Destination Charge	SLP in US \$
M1505_FREIGHT	UV34XL Diesel.....		\$1,520
M1507_FREIGHT	UV34XL Gas.....		\$1,520
M1511_FREIGHT	UV34XL Gas California.....		\$1,520

UV34 Bobcat Utility Vehicle

Part Number	Description	Dealer Installed Accessories - Order From Parts	SLP in US \$
-------------	-------------	---	--------------

Wheels & Tires

7027785	Rim - 12x6 (Orange)	\$ _____
	Models: UV34, UV34XL Factory standard orange wheels made with durable steel base and orange powder coat. For use with any 25" or 26" x 9-12 tire. Mounts on front axles. Includes two rear rims. Estimated install time 0.25 hours	
7023517	Rim - 12x8 (Orange)	\$ _____
	Models: UV34, UV34XL Factory standard orange wheels made with durable steel base and orange powder coat. For use with any 25" or 26" x 11-12 tire. Mounts on rear axles. Includes two rear rims. Estimated install time 0.25 hours	
7028398	Rim - 12x6 (Black)	\$ _____
	Models: UV34, UV34XL The sleek look of black wheels made with durable steel base and black powder coat. For use with any front 25" or 26" x 9-12 tire. Mounts on front axle, left or right. Includes two front rims. Estimated install time 0.25 hours	
7028397	Rim - 12x8 (Black)	\$ _____
	Models: UV34, UV34XL The sleek look of black wheels made with durable steel base and black powder coat. For use with any 25" or 26" x 11-12 tire. Mounts on the rear axle (left or right). Mounts on front axle, left or right. Includes two rear rims. Estimated install time 0.25 hours	
7360380	Tire - All Terrain HD - 8ply - 26x10-12	\$ _____
	Models: UV34, UV34XL Mounts on 12x9 steel rims (P/N 7027785 orange or 7028398 black) *UV34 Factory Tire* Estimated install time 0.5 hours	
7307679	Tire - Mud - 8ply - 26x9-12	\$ _____
	Models: UV34, UV34XL Mounts on 12x6 steel rims (P/N 7027785 orange or 7028398 black) Estimated install time 0.5 hours	
7307680	Tire - Mud - 8ply - 26x11-12	\$ _____
	Models: UV34, UV34XL Mounts on 12x8 steel rims (P/N 7023517 orange or 7028397 black) Estimated install time 0.5 hours	
7027654	Tire - All Purpose - 25x10-12	\$ _____
	Models: UV34, UV34XL General purpose front tires. Includes two front tires. Mounts on 12x6 steel rims (P/N 7027785 orange or 7028398 black). Rims sold separately. Estimated install time 0.5 hours	
7027655	Tire - All Purpose - 25x11-12	\$ _____
	Models: UV34, UV34XL General purpose rear tires. Includes two rear tires. Mounts on 12x8 steel rims (P/N 7023517 orange or 7028397 black). Rims sold separately. Estimated install time 0.5 hours	

UV34 Bobcat Utility Vehicle

Part Number	Description	Dealer Installed Accessories - Order From Parts	SLP in US \$
-------------	-------------	---	--------------

Windows & Doors

7496467	Doors - Poly Power Roll Down Glass (Front)	\$ _____
	Models: UV34, UV34XL	
	Front driver side and passenger side poly doors featuring power roll down glass windows, interior liner, and keyed locks.	
	Estimated install time 2.0 hours	
7360115	Doors - Poly w/Roll Down Glass	\$ _____
	Models: UV34, UV34XL	
	Driver side and passenger side poly doors featuring roll down glass windows, interior liner, and keyed locks.	
	Estimated install time 1.0 hours	
7360119	Doors - XL Poly w/Roll Down Glass (Rear)	\$ _____
	Models: UV34XL	
	Rear driver side and passenger side poly doors featuring roll down glass windows, interior liner, and keyed locks.	
	Estimated install time 1.0 hours	
7360052	Doors - Clear Poly (Front)	\$ _____
	Models: UV34, UV34XL	
	Front driver and passenger clear poly doors feature double hinged windows and keyed locks.	
	Estimated install time 1.0 hours	
7360054	Doors - Clear Poly (Rear)	\$ _____
	Models: UV34XL	
	Rear driver and passenger clear poly doors feature double hinged windows and keyed locks.	
	Estimated install time 1.0 hours	
7496463	Door - Poly Half (Front)	\$ _____
	Models: UV34, UV34XL	
	Front driver and passenger poly half doors feature an interior liner and an open-air experience.	
	Estimated install time 1.0 hours	
7496465	Door - Poly Half (Rear)	\$ _____
	Models: UV34XL	
	Rear driver and passenger poly half doors feature an interior liner and an open-air experience.	
	Estimated install time 1.0 hours	
7372485	Side Nets - Std	\$ _____
	Models: UV34, UV34XL	
	Includes Side Nets and hardware for first row of seating.	
	Estimated install time 1.0 hours	
7372486	Side Nets - XL	\$ _____
	Models: UV34XL	
	Includes Side Nets and hardware for second row of seating.	
	Estimated install time 1.0 hours	

UV34 Bobcat Utility Vehicle

Part Number	Description	Dealer Installed Accessories - Order From Parts	SLP in US \$
-------------	-------------	---	--------------

Windows & Doors - Continued

7360056	Windshield - Tip-Out Glass.....	\$ _____
	Models: UV34, UV34XL	
	The three position design with gas strut assist and grab handle for easy open and close operation.	
	Estimated install time 0.5 hours	
7489673	Windshield - Glass.....	\$ _____
	Models: UV34, UV34XL	
	This durable glass windshield is scratch resistant and provides reliable protection from wind, inclement weather and off-road hazards.	
	Estimated install time 0.5 hours	
7342776	Windshield - Poly with Hard Coat.....	\$ _____
	Models: UV34, UV34XL	
	This durable hard coat polycarbonate windshield is scratch resistant and provides reliable protection from wind, inclement weather and off-road hazards.	
	Estimated install time 0.25 hours	
7342427	Windshield - Poly.....	\$ _____
	Models: UV34, UV34XL	
	This durable polycarbonate windshield offers reliable protection from wind, inclement weather and off-road hazards.	
	Estimated install time 0.25 hours	
7343928	Windshield - Half Poly.....	\$ _____
	Models: UV34, UV34XL	
	Durable, polycarbonate half windshield provides riders with a mix of protection and airflow for an open-cab feel.	
	Estimated install time 0.25 hours	
7434447	Windshield Wiper & Washer.....	\$ _____
	Models: UV34, UV34XL	
	This kit includes a windshield wiper and a washer fluid reservoir to keep the windshield clean.	
	Estimated install time 0.75 hours	
7227941	Rear Panel - Sliding Glass.....	\$ _____
	Models: UV34, UV34XL	
	Added comfort and protection is available with this premium rear panel. Made of durable tempered glass with latching sliding windows for ventilation and rider comfort.	
	Estimated install time 0.5 hours	
7227939	Rear Panel - Glass.....	\$ _____
	Models: UV34, UV34XL	
	This durable glass windshield is scratch resistant and provides reliable protection from wind, inclement weather and off-road hazards.	
	Estimated install time 0.25 hours	
7348965	Rear Panel - Poly.....	\$ _____
	Models: UV34, UV34XL	
	This durable polycarbonate windshield offers reliable protection from wind, inclement weather and off-road hazards.	
	Estimated install time 0.25 hours	

UV34 Bobcat Utility Vehicle			
Part Number	Description	Dealer Installed Accessories - Order From Parts	SLP in US \$

Roofs

7340676	Roof - Sport Std.....	\$ _____
	Models: UV34	
	The durable and lightweight polyethylene roof provides overhead protection from the sun and elements.	
	Estimated install time 0.25 hours	
7360126	Roof - Headliner Std.....	\$ _____
	Models: UV34	
	Reduces cab noise and enhances comfort. Mounts on the Sport Roof (P/N 7340676).	
	Estimated install time 0.25 hours	
7360117	Roof - Sport XL.....	\$ _____
	Models: UV34XL	
	The durable and lightweight polyethylene roof provides overhead protection from the sun and elements.	
	Estimated install time 0.5 hours	
7360067	Roof - Headliner XL.....	\$ _____
	Models: UV34XL	
	Reduces cab noise and enhances comfort. Mounts on the Sport Roof XL (P/N 7360117).	
	Estimated install time 0.5 hours	

Racks & Storage

7497755	Storage - Aluminum Bed Box.....	\$ _____
	Models: UV34, UV34XL	
	Keep your gear organized and secure. However big or small this aluminum bed box will store and transport your gear.	
	Estimated install time 0.5 hours	
7308873	Rack - Tip-Down Headache Rack.....	\$ _____
	Models: UV34, UV34XL	
	This versatile Lock & Ride Tip Down Headache Rack provides extra storage flexibility and protects your cab when in the upright position.	
	Estimated install time 0.5 hours	
7308874	Rack - Cargo Box Rails.....	\$ _____
	Models: UV34, UV34XL	
	Adds tie down points to the sides of the box.	
	Estimated install time 0.5 hours	
7497754	Rack - Single Gun Boot Mount.....	\$ _____
	Models: UV34, UV34XL	
	Perfect for hunters, this Stronghold® Auto-Latch Gun Boot Mount provides a secure place to mount a gun boot so firearms can be transported safely without using up any cargo bed space.	
	Estimated install time 0.25 hours	
7496472	Rack - Double Gun Boot Mount.....	\$ _____
	Models: UV34, UV34XL	
	The Double Gun Boot Mount provides a secure place for two gun boots. The auto-latching design provides quick and secure attachment to your vehicle.	
	Estimated install time 0.5 hours	

UV34 Bobcat Utility Vehicle

Part Number	Description	Dealer Installed Accessories - Order From Parts	SLP in US \$
-------------	-------------	---	--------------

Racks & Storage - Continued

7497736	Storage - Gun Boot..... \$ _____ Models: UV34, UV34XL Safely secure your firearm in this lockable case that offers easy access and protection for your firearm (up to 52 inches in length). Requires Double Gun Boot Mount (P/N 7496472) or Single Gun Boot Mount (P/N 7497754) for secure transport. Estimated install time 1.0 hours
7497738	Rack - Roof Rack Mount..... \$ _____ Models: UV34 Easily install your Rhino-Rack® platform to the roof of your UTV with this mount. Once installed, load up gear for your next job or adventure. For use with the Rhino-Rack® system (rack sold separately). Estimated install time 0.5 hours
7497740	Rack - Roof Rack Mount (XL)..... \$ _____ Models: UV34XL Easily install your Rhino-Rack® platform to the roof of your UTV with this mount. Once installed, load up gear for your next job or adventure. For use with the Rhino-Rack® system (rack sold separately). Estimated install time 0.75 hours
7497742	Rack - Roof Rack..... \$ _____ Models: UV34 Carry your gear securely and efficiently with this rack. The Roof Rack Mount (P/N 7497738) is required. Estimated install time 1.0 hours
7497744	Rack - Roof Rack (XL)..... \$ _____ Models: UV34XL Carry your gear securely and efficiently with this rack. The Roof Rack Mount (P/N 7497740) is required. Estimated install time 1.5 hours
7496476	Rack - Multi-Purpose Tool Holder..... \$ _____ Models: UV34, UV34XL This pair of holders can hold a wide variety of long, narrow items, allowing you to easily swap by unclamping and securing your tools with the ratchet-locking mechanism. For use with the Rhino-Rack® platform system. Rack sold separately. Estimated install time 0.25 hours
7497748	Rack - Eyelet Tie-Downs..... \$ _____ Models: UV34, UV34XL The Eyelet Tie-Downs attach in multiple places on the platform to help you customize your load carrying setup. For use with the Rhino-Rack® system. Estimated install time 0.25 hours
7497746	Rack - Corner Cargo Bracket..... \$ _____ Models: UV34, UV34XL Easily transport your tools and gear with the Corner Cargo Bracket. The slotted base allows for increased maneuverability when installed. For use with the Rhino-Rack® system. Rack sold separately. Estimated install time 0.25 hours

UV34 Bobcat Utility Vehicle

Part Number	Description	Dealer Installed Accessories - Order From Parts	SLP in US \$
-------------	-------------	---	--------------

Racks & Storage - Continued

7497750	Rack - High-Lifting Jack Mount	\$ _____
	Models: UV34, UV34XL	
	Bring your jack everywhere you go so you are prepared to change a spare without compromising cab space or leaving your jack loose in the cargo box. For use with the Rhino-Rack® system. Rack sold separately.	
	Estimated install time 0.25 hours	
7497752	Rack - Multi Tool Rack	\$ _____
	Models: UV34, UV34XL	
	Securely carry up to 5 tools of all shapes and sizes with easy to operate rubber retention straps. The tool rack can be mounted inside or outside of the cargo box.	
	Estimated install time 0.5 hours	
7228079	Rack - Chainsaw Mount	\$ _____
	Models: UV34, UV34XL	
	Securely transport your chainsaw by adding a mount to the cargo box.	
	Estimated install time 0.25 hours	
7496475	Rack - Ratcheting Grip	\$ _____
	Models: UV34, UV34XL	
	Safely transport your tools or firearms with these Lock & Ride compatible ratcheting U-shaped grips. Includes two grips.	
	Estimated install time 0.25 hours	
7198444	Rack - Cargo Box Anchor	\$ _____
	Models: UV34, UV34XL	
	This anchor secures Lock & Ride compatible accessories to the cargo box.	
	Estimated install time 0.25 hours	

Safety & Comfort

7368503	Comfort - Heater Kit	\$ _____
	Models: UV34, UV34XL	
	Heat your cab in cold weather with this heater kit that includes all components needed to heat your UTV.	
	Estimated install time 3.0 hours	
7194742	Comfort - Grab Handle	\$ _____
	Models: UV34, UV34XL	
	Make entering and exiting easier by adding an additional grab handle.	
	Estimated install time 0.25 hours	
7496469	Safety - Rear View Mirror (Wide Angle)	\$ _____
	Models: UV34, UV34XL	
	The wide-angle 2.5" x 14" mirror gives you a full spectrum view.	
	Estimated install time 0.5 hours	
7311257	Safety - Rear View Mirror	\$ _____
	Models: UV34, UV34XL	
	The rear view mirror assists in the safe operation of your vehicle.	
	Estimated install time 0.5 hours	

UV34 Bobcat Utility Vehicle

Part Number	Description	Dealer Installed Accessories - Order From Parts	SLP in US \$
----------------	-------------	---	--------------

Safety & Comfort - Continued

7496471	Safety - Side View Mirrors (Door-Mounted).....	\$_____
	Models: UV34, UV34XL	
	The adjustable Door-Mounted Side View Mirrors provide increased visibility.	
	Estimated install time 0.5 hours	
7403508	Safety - Side View Swivel Mirror.....	\$_____
	Models: UV34, UV34XL	
	Increase visibility with these frame mounted side mirrors.	
	Estimated install time 0.5 hours	
7373325	Safety - Horn.....	\$_____
	Models: UV34, UV34XL	
	Make others aware of your presence with this horn kit.	
	Estimated install time 0.75 hours	
7374830	Safety - Turn Signal.....	\$_____
	Models: UV34, UV34XL	
	Add turn signals to the front and rear of your utility vehicle to alert others.	
	Estimated install time 1.0 hours	
7360113	Safety - Back-up Alarm.....	\$_____
	Models: UV34, UV34XL	
	The back-up alarm alerts others to your backing vehicle.	
	Estimated install time 0.5 hours	
7362499	Safety - Speed Kit (Gas).....	\$_____
	Models: UV34	
	Increase the top speed of your utility vehicle from 35 mph to 40 mph. The kit includes side nets.	
	Estimated install time 1.25 hours	
7405822	Safety - XL Speed Kit (Gas)	\$_____
	Models: UV34XL	
	Increase the top speed of your utility vehicle from 35 mph to 40 mph. The kit includes side nets.	
	Estimated install time 2.25 hours	
7362498	Safety - Speed Kit (Gas) - Flash Only	\$_____
	Models: UV34, UV34XL	
	Increase the top speed of your utility vehicle from 35 mph to 40 mph. Requires Preinstalled Side Nets or Doors for operator retention.	
	Estimated install time 0.25 hours	
7360127	Safety - 15mph Speed Limit Kit (Diesel).....	\$_____
	Models: UV34, UV34XL	
	Limits maximum speed to 15 mph.	
	Estimated install time 2.0 hours	

UV34 Bobcat Utility Vehicle

Part Number	Description	Dealer Installed Accessories - Order From Parts	SLP in US \$
-------------	-------------	---	--------------

Safety & Comfort - Continued

7360123	Safety - 25mph Speed Limit Kit (Diesel).....	\$ _____
	Models: UV34, UV34XL	
	Limits maximum speed to 25 mph.	
	Estimated install time 2.0 hours	
7269587	Safety - Box Tilt Safety Lock.....	\$ _____
	Models: UV34, UV34XL	
	Prevent your cargo box from tilting with the Box Tilt Safety Lock. This is recommended when using cargo box mounted attachments.	
	Estimated install time 0.5 hours	

Audio & Tech

7360129	Audio - Radio & Speakers.....	\$ _____
	Models: UV34, UV34XL	
	The audio system comes with an AM/FM tuner with an external antenna for reliable reception, a powerful amplifier, two robust 5.25 inch speakers, USB input and Bluetooth® capabilities.	
	Estimated install time 1.5 hours	
7360131	Audio - Rear Overhead Speakers.....	\$ _____
	Models: UV34, UV34XL	
	Enhance the audio in your cab with two 6.5 inch speakers that mount into the roof. Requires Radio Kit (P/N 7360129) and Roof (P/N 7340676 / 7360117).	
	Estimated install time 1.0 hours	
7360133	Tech - Garage Door Opener.....	\$ _____
	Models: UV34, UV34XL	
	The garage door opener installs directly into an available dash switch location and can be programmed to operate up to two doors	
	Estimated install time 1.0 hours	

Protection

7219854	Protection - Front Brush Guard.....	\$ _____
	Models: UV34, UV34XL	
	The Front Brush Guard protects to the front end of the vehicle from whatever obstacles you encounter. Not compatible with any Snow Blade Kit.	
	Estimated install time 0.5 hours	
7398465	Protection - Rear Brush Guard.....	\$ _____
	Models: UV34, UV34XL	
	The Rear Brush Guard protects the back end of the vehicle from whatever obstacles you encounter.	
	Estimated install time 0.5 hours	
7360060	Protection - Nerf Bars.....	\$ _____
	Models: UV34	
	Increase side protection with these durable nerf bars.	
	Estimated install time 1.0 hours	

UV34 Bobcat Utility Vehicle

Part Number	Description	Dealer Installed Accessories - Order From Parts	SLP in US \$
----------------	-------------	---	--------------

Protection - Continued

7360058	Protection - Nerf Bars (XL)..... \$ _____ Models: UV34XL Increase side protection with these durable nerf bars. Estimated install time 1.5 hours
----------------	--

Electrical & Lighting

7257391	Lighting - LED Light Bar..... \$ _____ Models: UV34, UV34XL Illuminate your work area with this set of lights. Lights can be mounted to cab frame or the roof. The Harness Adaptor Plug (P/N 7360277) is required, unless wiring direct to battery. Estimated install time 1.0 hours
7364082	Lighting - LED Work Lights (Front)..... \$ _____ Models: UV34, UV34XL Increase visibility with the two included LED lights. If mounting to the middle of the UTV is needed, a Power Redirect Harness (P/N 7365698) or Roof Power Bar (P/N 7360050) is required. Estimated install time 0.75 hours
7364120	Lighting - LED Work Lights (Rear)..... \$ _____ Models: UV34, UV34XL Increase visibility with the two included LED lights. If mounting to the middle or rear of the UTV is needed, a Power Redirect Harness (P/N 7365698) or Roof Power Bar (P/N 7360050) is required. Estimated install time 0.75 hours
7360121	Lighting - Multi-Function Cab Light..... \$ _____ Models: UV34, UV34XL This removeable Multi-Function Cab Light can be used as a flashlight in and around your UTV. The LED light can change from white, red, blue and green for a variety of uses. Requires the Roof (P/N 7340676 or P/N 7360117) and Power Bar (P/N 7360050) or Power Redirect Harness (P/N 7365698). Estimated install time 0.25 hours
7360320	Lighting - 360° Work Light..... \$ _____ Models: UV34, UV34XL Illuminate 360° around your vehicle with this foldaway work light. Estimated install time 1.0 hours
7364087	Lighting - Strobe Light..... \$ _____ Models: UV34, UV34XL The Strobe Light increases visibility in traffic or low visibility conditions. Requires a Power Redirect Harness (P/N 7365698) or Roof (P/N 7340676 or P/N 7360117) and Power Bar (P/N 7360050). Estimated install time 0.75 hours

UV34 Bobcat Utility Vehicle

Part Number	Description	Dealer Installed Accessories - Order From Parts	SLP in US \$
----------------	-------------	---	--------------

Electrical & Lighting - Continued

7360050	Electrical - Roof Power Bar.....	\$ _____
	Models: UV34, UV34XL Adds power access for cab mounted electrical accessories in the center or rear of your UTV. Requires Roof (P/N 7340676 or P/N 7360117). Estimated install time 0.5 hours	
7360277	Electrical - Power Bar Adaptor Plug.....	\$ _____
	Models: UV34, UV34XL This harness with connector and fuse link allows you to quickly install electrical accessories. Estimated install time 0.5 hours	
7365698	Electrical - Power Redirect Harness	\$ _____
	Models: UV34, UV34XL Allows for installation of key electrical accessories anywhere on the vehicle. Estimated install time 0.5 hours	
7489545	Electrical - Roof Light Harness.....	\$ _____
	Models: UV34, UV34XL Brings power to your roof mounted lights. Dash switch included. Estimated install time 0.5 hours	
7489547	Electrical - Roof Light Harness Extension (XL).....	\$ _____
	Models: UV34XL Brings power to your roof mounted lights. Dash switch included. Estimated install time 0.5 hours	

Utility

7360318	Utility - Power Cargo Box Lift.....	\$ _____
	Models: UV34, UV34XL Unload your box cargo with this electric box lift without leaving the driver seat. Estimated install time 0.5 hours	
7498373	Utility - Integrated Winch.....	\$ _____
	Models: UV34, UV34XL The Integrated Winch with a steel cable is rated to pull 4,500-lbs. Estimated install time 2.5 hours	
7385765	Utility - Multi-Mount Winch.....	\$ _____
	Models: UV34, UV34XL The Multi-Mount Winch with a steel cable is rated to pull 4,500-lbs. It can be mounted to the optional front or standard rear receiver hitch. Estimated install time 2.5 hours	
7219862	Utility - Front Receiver Hitch.....	\$ _____
	Models: UV34, UV34XL Add versatility to your UTV with this front mounted 2-inch receiver hitch. Estimated install time 1.0 hours	

UV34 Bobcat Utility Vehicle

Part Number	Description	Dealer Installed Accessories - Order From Parts	SLP in US \$
-------------	-------------	---	--------------

Utility - Continued

7372502	Utility - Air Filter Service Gauge.....	\$ _____
	Models: UV34, UV34XL	
	Easy-to-read gauge that indicates when air filter needs to be serviced.	
	Estimated install time 0.5 hours	
7327575	Utility - Fire Extinguisher Bracket.....	\$ _____
	Models: UV34, UV34XL	
	Allows you to safely secure a 3.25 inch diameter fire extinguisher (not included).	
	Estimated install time 0.5 hours	
7397972	Utility - Diesel Engine Block Heater.....	\$ _____
	Models: UV34, UV34XL	
	Improve cold starts and start up lubrication of your diesel engine by adding a block heater.	
	Estimated install time 0.5 hours	
7261292	Utility - Heated Battery Blanket	\$ _____
	Models: UV34, UV34XL	
	Improve starting ability in cold weather by warming the battery core with this Heated Battery Blanket.	
	Estimated install time 1.0 hours	
7498184	Utility - Snow Blade Kit.....	\$ _____
	Models: UV34, UV34XL	
	Durable 72" wide x 21" tall poly snow plow blade with double wall reinforcement. Deep 6" radius rolls and moves snow for quick and easy plowing. Integrated winch p/n 7385761 required to operate snow	
	Estimated Install Time 1.5 Hours	

UV34 Bobcat Utility Vehicle Attachment

Part Number	Description	Attachment	SLP in US \$
-------------	-------------	------------	--------------

7444035	SP9 Sand/Salt Spreader.....		\$6,387.00
	(Includes controller, wire harness and all necessary mounting hardware) required to have either the Electrical, Power Cargo Box Lift (Part #7360318) or the Box, Hold Down Kit (Part # 7269587)		

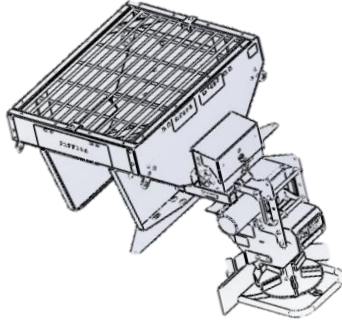

Part Number	Description	SP9 Sand/Salt Spreader Accessories - Order From Parts	SLP in US \$
-------------	-------------	---	--------------

For current Dealer Installed Accessories pricing, reference BobQuote or Dealer Parts Department.

7455397	V Inverted Kit.....	Parts	\$ ____
7455399	Work Light Kit.....	Parts	\$ ____
7455400	Strobe Light Kit.....	Parts	\$ ____
7455401	Vibrator Kit.....	Parts	\$ ____
7455402	Spill Guard Kit.....	Parts	\$ ____
7455398	Tarp.....	Parts	\$ ____

Attachment	Assembly Required	Installation Time (Hours)
------------	-------------------	---------------------------

Sand/Salt Spreader.....	Install spreader, control kit and harness.....	4.00
Rear spreader work light kit.....	Mount taillight assemblies.....	1.00

Destination Charge/Fuel Surcharge

Refer to BobQuote or BobcatNET>>Other Resources>>Pricing Homepage for current Destination and Fuel Charges.

UV34 Bobcat Utility Vehicle Attachment

Part Number	Description	Attachment	SLP in US \$
-------------	-------------	------------	--------------

7519472	72HDVB 72" Heavy-Duty V-Blade		\$5,864.00
---------	-------------------------------------	--	------------

Professional-grade plowing performance with the Heavy-Duty V-blade. For maximum versatility, the plow quickly configures from straight, to scoop, to V at the touch of a button, angling to 5' wide to cater to most sidewalks and fit through gates.

(Includes controller, wire harness and all necessary mounting hardware)

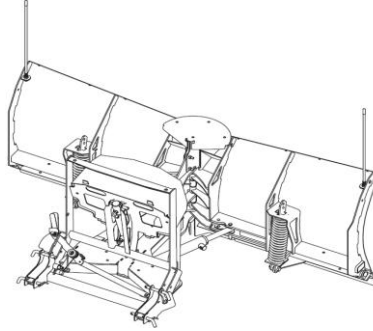

Part Number	72HDVB 72" Heavy-Duty V-Blade Accessories - Order From Parts	Description	SLP in US \$
-------------	--	-------------	--------------

For current Dealer Installed Accessories pricing, reference BobQuote or Dealer Parts Department.

7535391	Heavy-Duty V-Blade Rubber Deflector Kit.....	Parts	\$ ____
7535393	Heavy-Duty V-Blade Poly Cutting Edge Kit.....	Parts	\$ ____
7535395	Heavy-Duty V-Blade Shoe Assembly Kit	Parts	\$ ____

Attachment	Assembly Required	Installation Time (Hours)
------------	-------------------	---------------------------

Heavy-Duty V-Blade.....	Install frame mounts, blade, control kit and harness.....	3.50
-------------------------	---	------

Destination Charge/Fuel Surcharge

Refer to BobQuote or BobcatNET>>Other Resources>>Pricing Homepage for current Destination and Fuel Charges.

UV34 Bobcat Utility Vehicle Attachment

Part Number	Description	Attachment	SLP in US \$
-------------	-------------	------------	--------------

7527320	72HDSB 72" Heavy-Duty Straight-Blade.....		\$4,685.00
---------	--	--	-------------------

Professional-grade plowing performance with the Heavy-Duty Straight blade. The heavy-duty, yet lightweight design allows it to handle sidewalks, paved walkways, and other tight areas with ease.
(Includes controller, wire harness and all necessary mounting hardware)

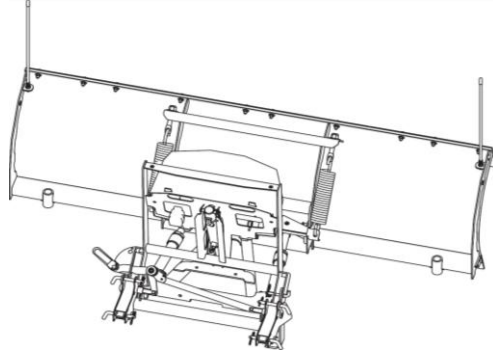

Part Number	72HDSB 72" Heavy-Duty Straight-Blade Accessories - Order From Parts	Description	SLP in US \$
-------------	---	-------------	--------------

For current Dealer Installed Accessories pricing, reference BobQuote or Dealer Parts Department.

7535375	Heavy/Mid-Duty Straight-Blade Rubber Deflector Kit.....	Parts	\$ ____
7535381	Heavy-Duty Straight-Blade Poly Cutting Edge Kit.....	Parts	\$ ____
7535383	Heavy-Duty Straight-Blade Shoe Assembly Kit	Parts	\$ ____

Attachment	Assembly Required	Installation Time (Hours)
------------	-------------------	---------------------------

Heavy-Duty Straight-Blade.....	Install frame mounts, blade, control kit and harness.....	3.00
--------------------------------	---	------

Destination Charge/Fuel Surcharge

Refer to BobQuote or BobcatNET>>Other Resources>>Pricing Homepage for current Destination and Fuel Charges.

UV34 Bobcat Utility Vehicle Attachment

Part Number	Description	Attachment	SLP in US \$
-------------	-------------	------------	--------------

7527328	72MDSB 72" Mid-Duty Straight-Blade.....		\$4,161.00
---------	---	--	------------

High-strength materials and a lightweight design provide a tailored snow removal solution for utility vehicles.

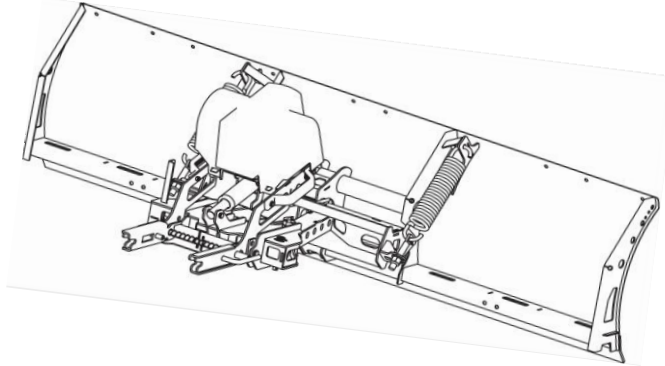

Part Number	72MDSB 72" Mid-Duty Straight-Blade Accessories - Order From Parts Description	SLP in US \$
-------------	---	--------------

For current Dealer Installed Accessories pricing, reference BobQuote or Dealer Parts Department.

7535375	Heavy/Mid-Duty Straight-Blade Rubber Deflector Kit.....	Parts	\$ ____
7535377	Mid-Duty Straight-Blade Poly Cutting Edge Kit.....	Parts	\$ ____
7535379	Mid-Duty Straight-Blade Show Assembly Kit.....	Parts	\$ ____

Attachment	Assembly Required	Installation Time (Hours)
------------	-------------------	---------------------------

Mid-Duty Straight-Blade.....	Install frame mounts, blade, control kit and harness.....	3.00
------------------------------	---	------

Destination Charge/Fuel Surcharge

Refer to BobQuote or BobcatNET>>Other Resources>>Pricing Homepage for current Destination and Fuel Charges.

UV34 Bobcat Utility Vehicle Attachment

Part Number	Description	Attachment	SLP in US \$
46916137	Throated Broadcast Spreader.....		\$1,677.00
	UTV Integration Kit 46920613 is REQUIRED for Broadcast Spreader		
46916139	Electric Gate Broadcast Spreader.....		\$2,411.00
	UTV Integration Kit 46920613 is REQUIRED for Broadcast Spreader		



Part Number	Description	Broadcast Spreaders Accessories - Order From Parts	SLP in US \$
<i>For current Dealer Installed Accessories pricing, reference BobQuote or Dealer Parts Department.</i>			

Attachment	Assembly Required	Installation Time (Hours)
------------	-------------------	---------------------------

Destination Charge/Fuel Surcharge
Refer to BobQuote or BobcatNET>>Other Resources>>Pricing Homepage for current Destination and Fuel Charges.

UV34 Bobcat Utility Vehicle Attachment
Part Attachment

Number	Description	SLP in US \$
46916144	2.5 Cu Ft. Drop Spreader.....	\$4,507.00
	UTV Integration Kit 46920869 is REQUIRED for Drop Spreader	
46916147	6.0 Cu Ft. Drop Spreader.....	\$4,926.00
	UTV Integration Kit 46920869 is REQUIRED for Drop Spreader	



Drop Spreaders Accessories - Order From Parts		
Part Number	Description	SLP in US \$
<i>For current Dealer Installed Accessories pricing, reference BobQuote or Dealer Parts Department.</i>		

Attachment	Assembly Required	Installation Time (Hours)
------------	-------------------	---------------------------

Destination Charge/Fuel Surcharge
Refer to BobQuote or BobcatNET>>Other Resources>>Pricing Homepage for current Destination and Fuel Charges.